



yes. everything. one source.

JUMP TO  
SPECS 



# GRID

STORAGE

In partnership with



*British-made, sustainable*  
**OFFICE FURNITURE**



## GRID STORAGE

Flexible working has transformed the way we use office spaces, placing greater emphasis on environments that support both collaboration and individual focus.

With its smart, modular design, Grid can be configured - and then reconfigured - as often as needed, making it easy to adapt to changing team sizes, workstyles or layouts. Whether you're creating an open collaboration zone, a quiet breakout area or a temporary project hub, Grid provides the flexibility to shape your space in real time, without the hassle.

## GRID STORAGE

### SPECIFICATIONS

#### CUBES

**Width:** 368-1000mm

**Depth:** 400/468mm

**Height:** 368-1000mm

25mm thick MFC board, 18mm thick carcass

Cupboard and Floor Base includes hidden adjustable feet

### ACCESSORIES

Grid Cupboards are customisable with a wide range of handles or customised without handles or drill holes. Please see our Product Guide to see the full selection.

Lockers have choice of Pull-Handle or Combination Locks.

### QUALITY

This range has been designed and manufactured to our high standards of quality and is guaranteed for 10 years.

### CONFORMITY

We endeavour to only source products from FSC® certified suppliers. FSC® certified timber products are available on request. (License Holder FSC®C199861).



The mark of  
responsible forestry  
FSC® C199861

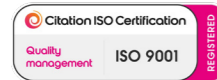

## SHAPES & STYLES



Grid Cupboard



Floor Base



Locker



Shelf 18mm



Cube



Open Alcove



Alcove



Stainless Steel  
Plant Hanger



Planter

## GRID STORAGE

# GRID STORAGE

## CONFIGURATIONS

Our Grid Storage system is designed for ultimate flexibility and can be configured to suit a wide range of spaces. Here are some of our favourite combinations.



- 1** Cupboard Base
- Lockers
- Alcoves
- Planters
- Plant Hanger



- 2** Floor Base
- Lockers
- Alcoves
- Open Alcoves
- Planters
- Plant Hanger
- Shelf



- 3** Floor Base
- Lockers
- Open Alcoves
- Shelves
- Planters
- Plant Hangers



- 4** Cupboard Base
- Planters



- 5** Cupboard Base
- Locker
- Open Alcove
- Planter
- Shelf
- Plant Hanger



- 6** Cupboard Base
- Floor Base
- Lockers
- Open Alcove
- Alcoves
- Planter
- Shelves
- Plant Hanger



## METALWORK FINISHES



(B) Black (Textured)



(G) Grey (Textured)



(S) Silver

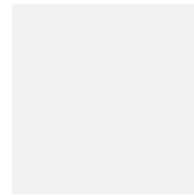

(W) White



(A) Anthracite



(AB) Anodic Bronze



(LQ) Clear Lacquer (Matt)



(DT) Deep Teal



(OG) Olive Grey



(C) Chestnut



(DB) Distant Blue



(PL) Plum

## MFC FINISHES

### BAND 1



(BE) Beech



(CA) Classic Ash



(LO) Light Oak



(MO) Modern Oak



(MA) Maple



(PG) Plain Grey



(SE) Swiss Elm



(VO) Verade Oak

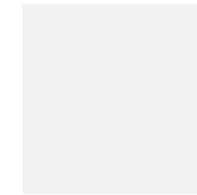

(WH) White

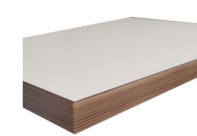

Ply Edging

### BAND 2



(AN) Anthracite



(BK) Black



(CO) Concrete

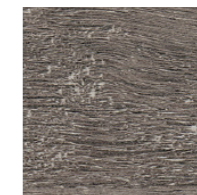

(GO) Grey Oak



(WO) White Oak



(DW) Dijon Walnut

### BAND 3



(HO) Halifax Oak

**IMPORTANT: MFC and Metal Finishes shown here are for illustration purposes only.**

⚠ Please do not try to colour match. If trying to match against existing colours please call and ask for a sample card to be posted. Different coloured metalwork are available, prices provided on application. Furniture that requires bungs (e.g. Solo) will be supplied with black inserts, except Giorgio which has a choice of Black, White, Grey or Silver.

## SUSTAINABILITY INFORMATION

### POWERED BY SOLAR

Our factory roof is fitted with solar panels, supplying over 50% of our power needs. Given the energy-intensive nature of furniture manufacturing, these panels are crucial to Hawk's net zero carbon initiative. Since October 2022 our solar system has logged a reduction in CO<sub>2</sub> of 285t, an equivalent of planting 158 trees and a saving of 114t of standard coal.

### BIOMASS BURNER

In addition to sourcing sustainable and certified board, we take extra measures to reduce our carbon footprint. Waste board is utilised to power our cutting-edge biomass burner, while larger off-cuts are repurposed for the core of our budget-friendly screens. This not only helps in offering competitively-priced desk screens but also contributes to warming our factory and powder-coating ovens, significantly cutting down on energy consumption.

### SCOPE 1, 2 & 3 EMISSIONS

Scope 2 emissions of as little as 3.1kg per product manufactured\*. Figures calculated based on 2021 usage and do not include reduction of energy that the solar panels provide (only installed in 2022).

### RESPONSIBLE MANUFACTURING

We endeavour to only source products from FSC® certified suppliers. FSC® certified timber products are available on request. (License Holder FSC®C199861).

### OUR FLEET

Our company owned vehicles are all hybrid or electric.

### NOTES ON EMISSIONS

Scope 3 is estimated and not feasible to include as Hawk has very little control over the products once they are sold into the trade (emissions of the distributor, how far they travel to deliver and what happens at the product end of life)

*\*Taken as an average over all products sold in 2021 emissions are calculated from Normative Carbon Accounting Engine and include all available data. Where no such data exists, a calculated estimate has been substituted.*

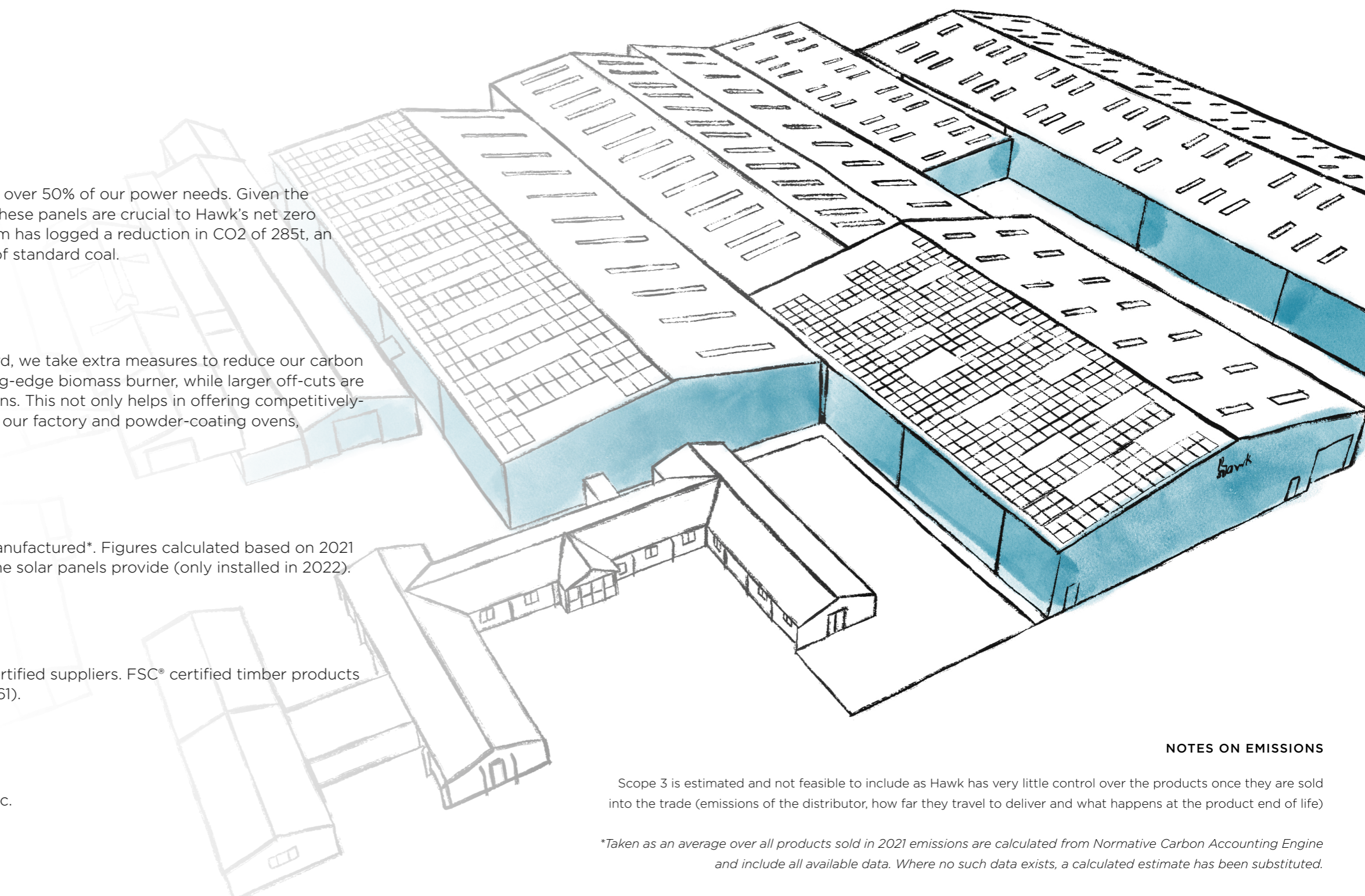

## MATERIALS OVERVIEW

### MFC RECYCLABLE CONTENT

The bioeconomy, a prominent resource-saving approach, states: It is better to use raw materials that regrow within a time frame of a generation than raw materials that take millions of years to regenerate.

Melamine Faced Chipboard used in the manufacture of office furniture at Hawk has been sourced from FSC® & PEFC certified suppliers. An assurance that the product that you are buying is from a sustainably managed forest.

The MFC boards that we source are made from approximately **88%** wood and paper with the exception of White, which is virgin wood and offset with the planting of trees by the supplier.

### STEEL RECYCLABLE CONTENT

The production of tube comes from purchases of raw material from steel mills, that employ two different production processes:

- BOF technology (steel from oxygen furnaces), with a scrap content of 15-25%
- EAF technology (steel from electric furnaces), with a scrap content of 80-90%

The type of supplied product shall be (unless different requirements are stated at the point of order) one of these two manufacturing processes, according to availability.

## CLEANING & CARE INSTRUCTIONS

### CLEANING & CARE INSTRUCTIONS

MFC is the most practical and low maintenance material for use in an office environment, offering the following benefits:

- Scratch resistant
- Resistant to household cleaning products and chemicals
- Resistant to cigarette burns
- Colour-fastness under artificial light
- Resistant to cracking
- Impact resistance
- Abrasion resistant
- Ease of maintenance
- Hygienic surface

### LIGHT SOILING

Clean with a paper towel, a soft clean cloth (dry/damp) or a sponge. If using a damp cloth, dry the surface with an absorbent paper towel or microfibre cloth.

### NORMAL SOILING / EXTENDED CONTACT

Clean with a paper towel, a soft clean cloth (dry/damp) or a sponge. If using a damp cloth, dry the surface with an absorbent paper towel or microfibre cloth. Clean with warm water, a clean rag or microfibre cloth, a soft sponge or soft brush. Use normal domestic cleaners or soaps that have no abrasive ingredients. Then wipe with fresh water, removing all traces of the cleaning agent, to prevent streaks forming. Dry the surface with a clean, absorbent cloth or paper towels.

The following cleaning agents should not be used under any circumstances:

- Scouring and abrasive agents (abrasive powders, scouring pads, steel wool)
- Polish, washing powder, furniture cleaner, bleach
- Detergents with strong acids and acidic salts
- Steam cleaning equipment

### METALWORK

Metalwork is polyester-resin powder-coated and resistant to minor scratching, chipping, abrasions, cracking and daily wear and tear and therefore only requires regular dusting and occasionally washing down with luke-warm soapy water if required. No strong detergents are required.



yes. everything. one source.

01226 98 22 98 | [sales@bos4you.co.uk](mailto:sales@bos4you.co.uk)

BOS Office Supplies Limited

6 McLintock Way

Barnsley S70 6BF

[www.bos4you.co.uk](http://www.bos4you.co.uk)